

## Model I Weld

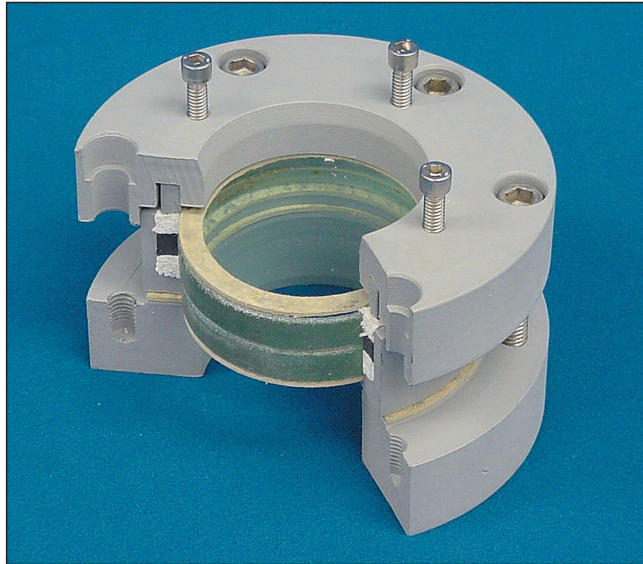

### Description:

The Model I Weld unit is a combination sight glass and a weld pad. The weld pad is designed to be welded to new or existing equipment to become an integral part of the vessel wall, vessel head, manway cover or in a pipeline system. It is available with the weldment contoured to fit a specific radius (cylindrical or spherical); the sight glass is bolted on the weld pad. The Model I Weld is designed for sizes from 2" to 8."

### Materials of Construction:

- 1. Weld Pad:** 316 or 304 Stainless Steel SA-351 or SA-240; Carbon Steel PVQ; Hastelloy; Alloy 20; Titanium; Monel; etc.
- 2. Flange:** 316 or 304 Stainless Steel SA-351; Carbon Steel SA-519 or PVQ
- 3. Insert:** 316 or 304 Stainless Steel SA-351; Carbon Steel SA-519; Hastelloy; Alloy 20; Titanium; Monel; etc.
- 4. Compression Ring:** 304 Stainless Steel SA-351; Carbon Steel SA-519
- 5. Lens:** Two-Piece Laminated Tempered Soda Lime (Standard); Tempered or Annealed Borosilicate; Quartz; Lexan; Acrylic; Mica Shields
- 6. Lens Cushion Gaskets:** Teflon®; Grafoil®, Gylon®, Blue-Gard®, etc.
- 7. Lens Packing:** Combination Teflon® Impregnated and Viton® (Standard); Graphite; FDA Teflon®, etc.
- 8. Retainer Bolts:** 18-8 Stainless Steel; Carbon Steel SA-193
- 9. Compression Screws:** 18-8 Stainless Steel; Carbon Steel SA-193
- 10. Mating Gasket:** Gylon®, Teflon®, Grafoil®, Blue-Gard®, etc.

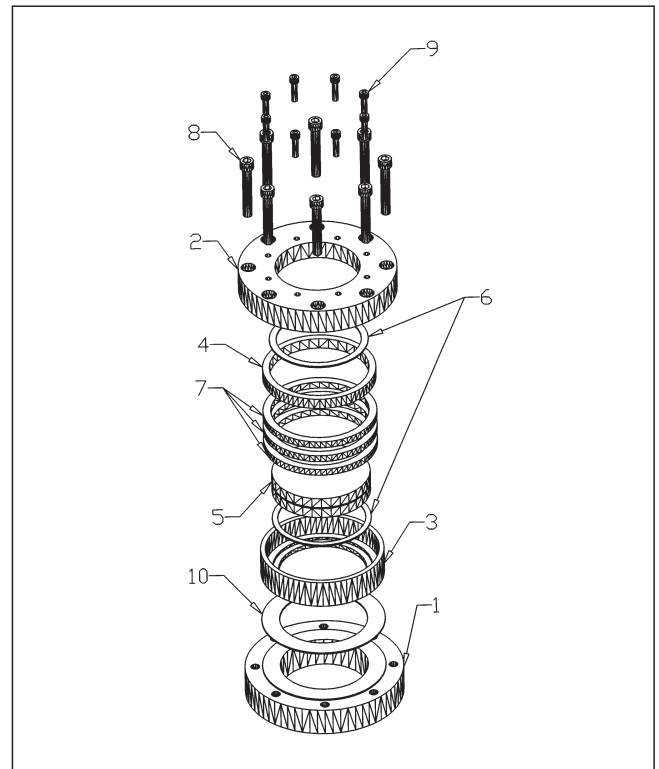

MADE IN THE USA

